

INLET - 8" 150# FLANGE
 OVERFLOW - 2 1/2" N.P.T.
 VENT - 4" N.P.T.
 DRAIN - 1" N.P.T.

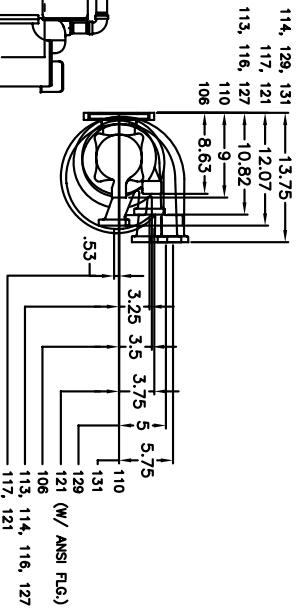

RECOMMENDED DISCHARGE NOZZLE SIZE CAPACITY CHART	3/4"
0-15	1"
16-60	OR 1 1/2"
61-113	2"
114-150	2 1/2"
151-250	3"
251-400	4"

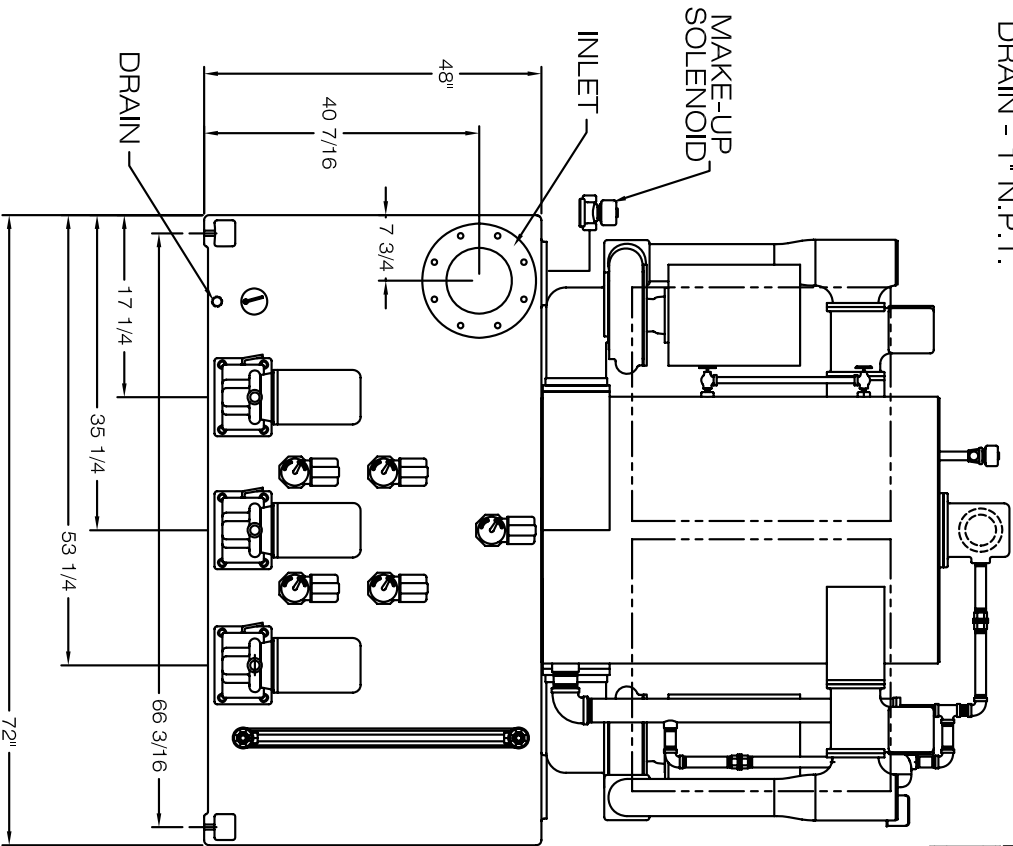
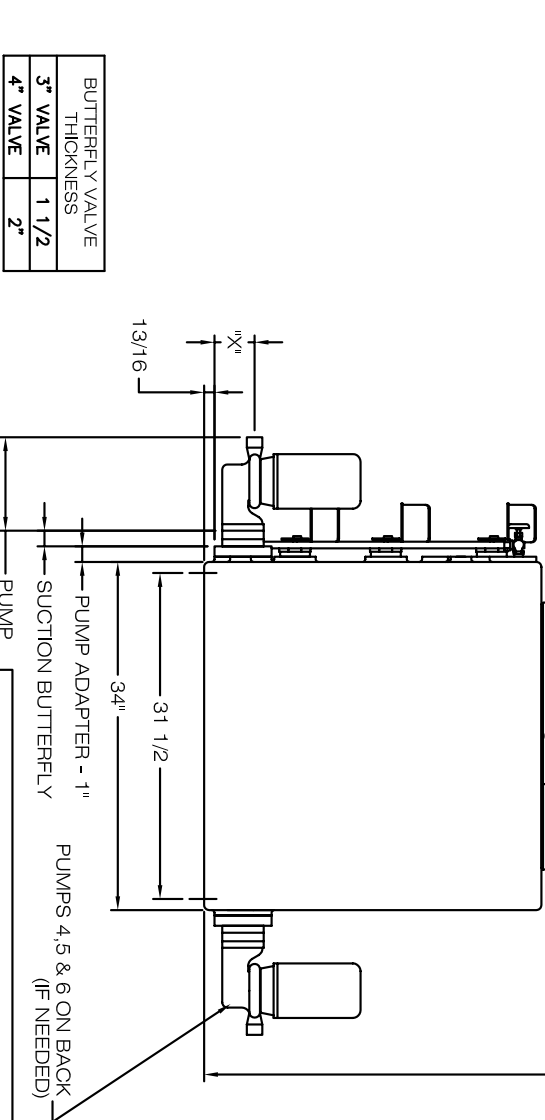

BUTTERFLY VALVE THICKNESS	1 1/2"
3" VALVE	1 1/2"
4" VALVE	2"

SHIPCO®
 PUMPS

MANUFACTURED BY
 SHIPPENSBURG PUMP COMPANY INC.
 P.O. Box 279 Shippensburg, Pa. 17257
 PHONE 717 532-7321 / FAX 717 532-7704
 WWW.SHIPCO.PUMPS.COM

SHIPCO® IS A REGISTERED TRADEMARK OF SHIPPENSBURG PUMP CO., INC.

1"X" DIMENSION

PUMP MODELS		114 & 129	114 & 129
110	106	113, 116 & 127	117 & 121
3, 13	3, 31	4, 19	3, 82
		UNDER 130 GPM	130 GPM & OVER
		4, 50	6, 32
			7, 00

Type BVC and Type BVMC
 Vacuum Receiver-53 to 100 CFM
 or Boiler Feed Receiver

DRAWN BY	DATE	REVISION
J. BROOKENS	11/09	.6