

# SHIPCO PUMPS

MANUFACTURED BY

SHIPPENSBURG PUMP COMPANY INC.

P.O. Box 279 Shippensburg, Pa. 17257

PHONE 717 532-7321 / FAX 717 532-7704

WWW.SHIPCO.PUMPS.COM

SHIPCO® IS A REGISTERED TRADEMARK OF SHIPPENSBURG PUMP CO., INC.

## 114 Model P Horiz End Suction JM Frames 213 & 215 Above 130 GPM

DRAWN BY M.LINEAWEAVER DATE 9/04 REVISION .6

PARTS LIST # PL-81416

QUEB PART # 114PHJM+L

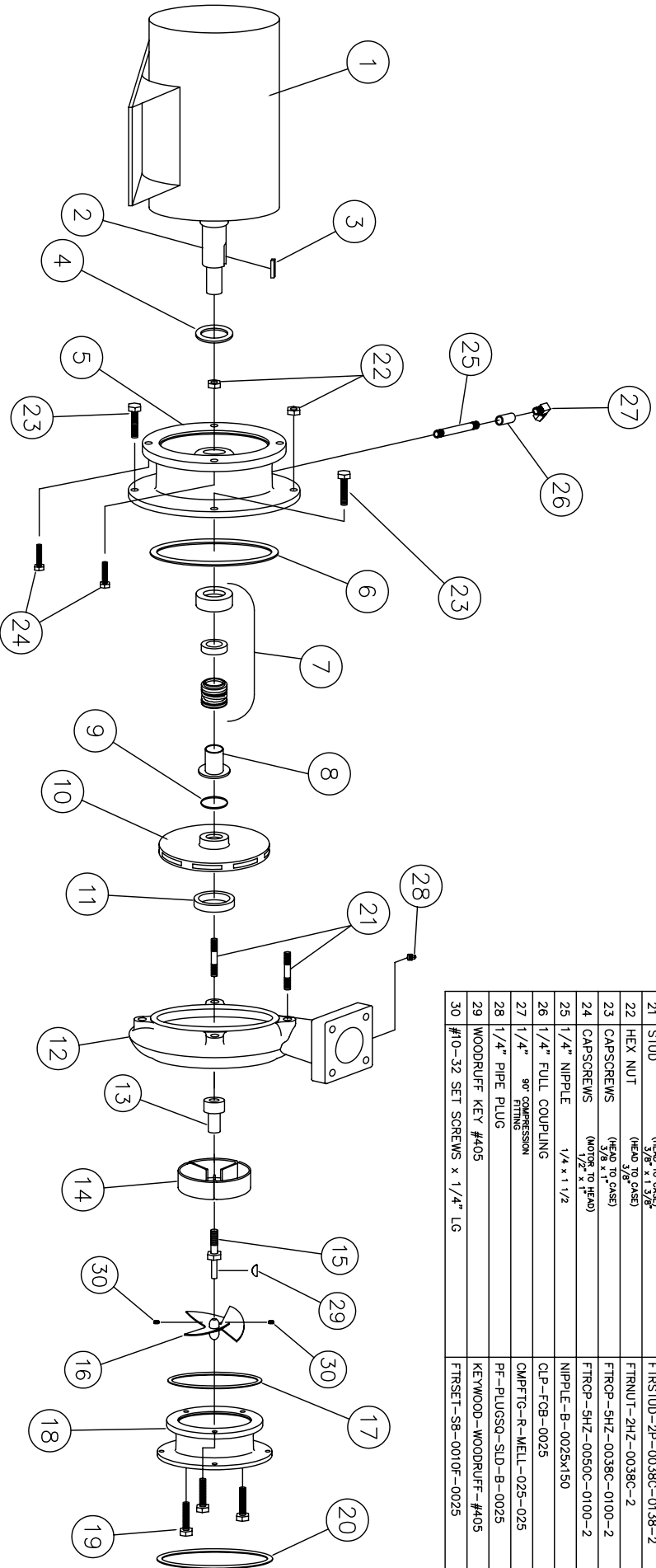

### PARTS LIST

NO.	DESCRIPTION	PART NO.	QTY.
1	MOTOR	JM FRAME	1
2	MOTOR SHAFT		1
3	KEY (MOTOR TO IMPELLER)	KEYBAR-S8-019-0VR	1
4	WATER SLINGER	SLINGER-SDWS99998	1
5	PUMP HEAD	HEAD-SDPH00133-1	1
6	HEAD GASKET	GASKET-SDPG03826	1
7	MECHANICAL SEAL 1 1/8"	MCHSEAL-SDP500155	1
8	SHAFT SLEEVE	SHTSLVE-SDP00218	1
9	"O" RING (SHAFT SLEEVE)	ORING-SDP000051	1
10	IMPELLER	IMP-SDPH00147-A	1
11	WEARING RING	WRGRING-SDPWR0068	1
12	PUMP CASE	CASE-SDPC00148-B	1
13	PROPELLER STEM	PROPSTM-SDP500669	1
14	STRAIGHTENING VANES	STRVANE-SDP500139	1
15	PROPELLER STEM BOLT	PROPSTM-SDP500670	1
16	PROPELLER	PROPELL-SDPP00660	1
17	SUCTION HOUSING GASKET	GASKET-SDPG03836	1
18	SUCTION HOUSING	SUCHSG-SDPF00025-A	1
19	CAPSCREWS (SUCTION HOUSING TO CASE)	FTRCP-5HZ-0038C-0125-2	3
20	SUCTION GASKET	FG-ASA-SP15-GKT-0400	1
21	STUD	FTRSTUD-2P-0038C-0138-2	2
22	HEX NUT	FTRNUT-2HZ-0038C-2	2
23	CAPSCREWS (HEAD TO CASE)	FTRCP-5HZ-0038C-0100-2	2
24	CAPSCREWS (MOTOR TO HEAD)	FTRCP-5HZ-0050C-0100-2	4
25	1/4" NIPPLE	NIPPLE-B-0025x150	1
26	1/4" FULL COUPLING	CLP-FCB-0025	1
27	1/4" 90° COMPRESSION FITTING	OMPFTG-R-MELL-025-025	1
28	1/4" PIPE PLUG	PF-PLUGSQ-SLD-B-0025	1
29	WOODRUFF KEY #405	KEYWOOD-WOODRUFF-#405	1
30	#10-32 SET SCREWS x 1/4" LG	FTRSET-SB-0010F-0025	2