

SHIPCO PUMPS

MANUFACTURED BY
 SHIPPENSBURG PUMP COMPANY INC.
 P.O. Box 279 Shippenburg, Pa. 17257
 PHONE 717 532-7321 / FAX 717 532-7704
 WWW.SHIPCO.PUMPS.COM
 SHIPCO® IS A REGISTERED TRADEMARK OF SHIPPENSBURG PUMP CO., INC.

116 Model P Horiz End Suction 56J Frame

DRAWN BY J.BROOKENS DATE 4/05 REVISION .5

PARTS LIST # PL-81606

QUBE PART # 116PH56J

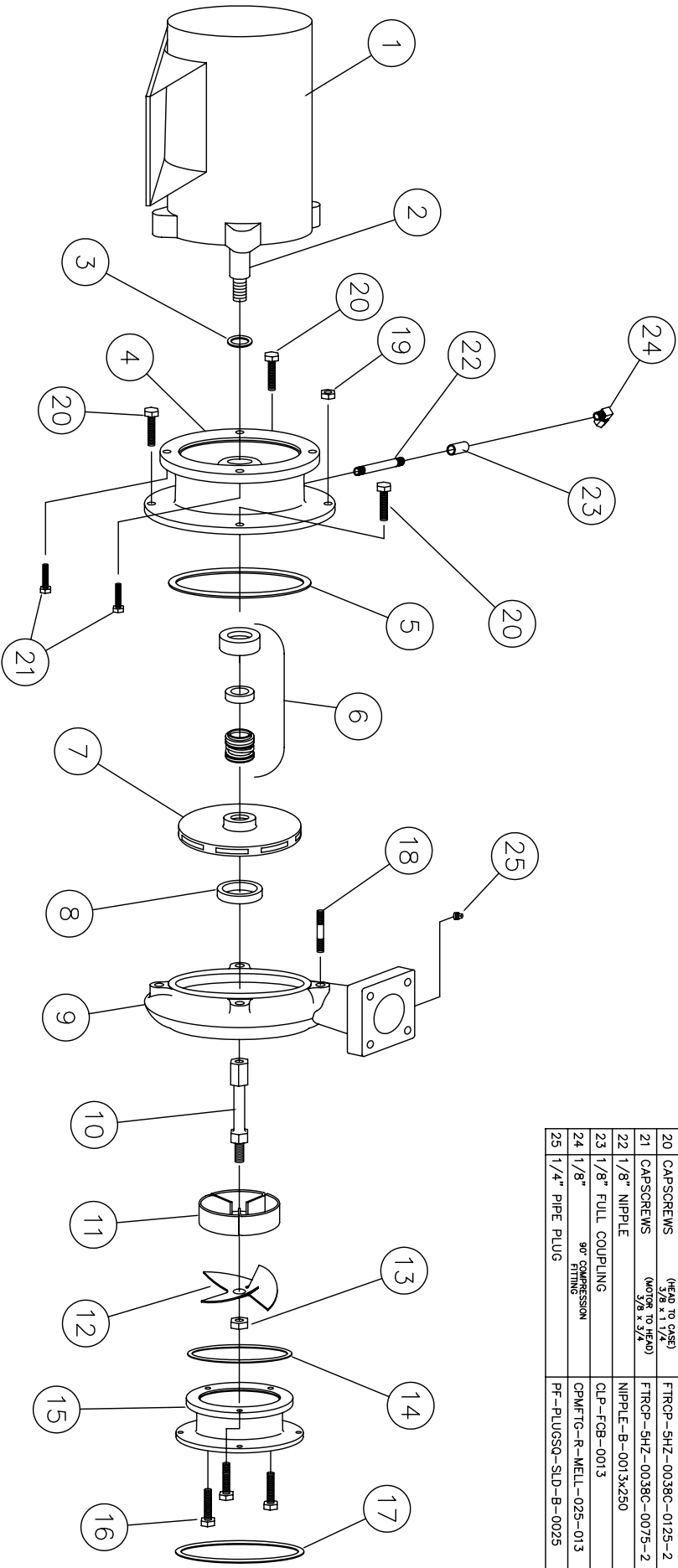

| NO. | DESCRIPTION | PART NO. | QTY. |
|-----|-------------------------------------|-------------------------------|------|
| 1 | MOTOR | 56J FRAME | 1 |
| 2 | MOTOR SHAFT | SLINGER-SDWS99999 | 1 |
| 3 | WATER SLINGER | HEAD-SDPH00040 | 1 |
| 4 | PUMP HEAD | GASKET-SDPG03827 | 1 |
| 5 | HEAD GASKET | MCHSEAL-SDPS00067 | 1 |
| 6 | MECHANICAL SEAL 5/8" | IMP-SDP100042 | 1 |
| 7 | IMPELLER | WRGRING-SDPW00032 | 1 |
| 8 | WEARING RING | CASE-SDPC00041 | 1 |
| 9 | PUMP CASE | PROPSTM-SDPS00312 | 1 |
| 10 | PROPELLER STEM | STRVANE-SDPS00121 | 1 |
| 11 | STRAIGHTENING VANES | PROP-SDPP00142 | 1 |
| 12 | PROPELLER | FTRNUT-HS8-0025F-2 | 1 |
| 13 | HEX NUT | FTRNUT-HS8-0025F-2 | 1 |
| 14 | SUCTION HOUSING GASKET | GASKET-SDPG03829 | 1 |
| 15 | SUCTION HOUSING | SUCHSG-SDPF00050-A | 1 |
| 16 | CAPSCREWS (SUCTION HOUSING TO CASE) | FTRCP-5HZ-0038C-0100-2 | 3 |
| 17 | SUCTION GASKET | FLG-ASA-SPT5-GKT-0300 | 1 |
| 18 | STUD | FTRSTUD-2P-0038C-0138-2 | 1 |
| 19 | HEX NUT | (HEAD TO CASE) 3/8 x 1 3/8 | 1 |
| 20 | CAPSCREWS | (HEAD TO CASE) 3/8 x 1 1/4 | 3 |
| 21 | CAPSCREWS | (MOTOR TO HEAD) 3/8 x 3/4 | 4 |
| 22 | 1/8" NIPPLE | NIPPLE-B-0013x250 | 1 |
| 23 | 1/8" FULL COUPLING | CLP-FGB-0013 | 1 |
| 24 | 1/8" 90° COMPRESSION FITTING | CFMFTG-R-MELL-025-013 | 1 |
| 25 | 1/4" PIPE PLUG | PF-PLUGSQ-SLD-B-0025 | 1 |