

SHIPCO PUMPS

MANUFACTURED BY
 SHIPPENSBURG PUMP COMPANY INC.
 P.O. Box 279 Shippenburg, Pa. 17257
 PHONE 717 532-7321 / FAX 717 532-7704
 WWW.SHIPCO.PUMPS.COM
 SHIPCO® IS A REGISTERED TRADEMARK OF SHIPPENSBURG PUMP CO., INC.

127 Model P Horiz End Suction JM Frames 143, 145, 182, & 184

DRAWN BY M. LINEAWEAVER	DATE 9/04	REVISION .6
PARTS LIST # PL-82713	QUBE PART # 127PHJM	

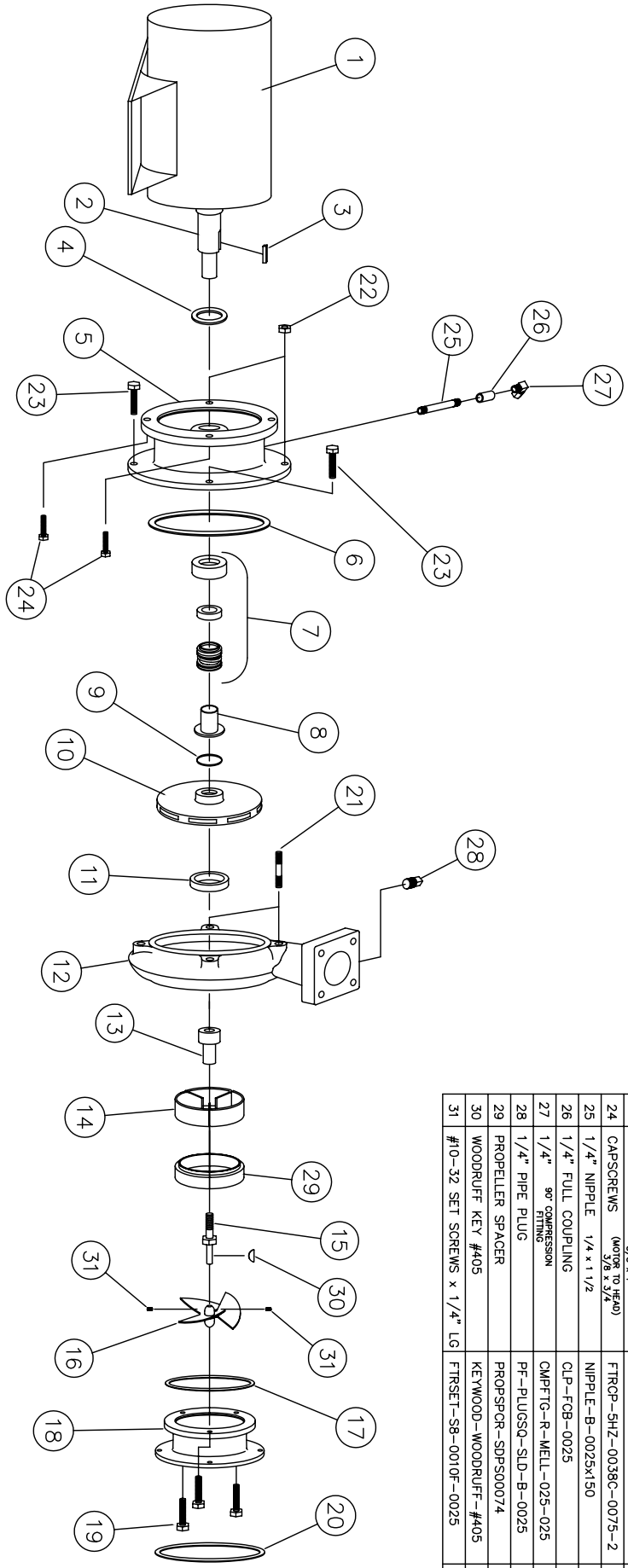

NO.	DESCRIPTION	PART NO.	QTY.
1	MOTOR	JM FRAME	1
2	MOTOR SHAFT		1
3	KEY (MOTOR TO IMPELLER)	KEYBAR-S8-019-OVR	1
4	WATER SLINGER	SLINGER-SDWS99998	1
5	PUMP HEAD	HEAD-SDPH00133	1
6	PUMP HEAD GASKET	GASKET-SDPG03826	1
7	MECHANICAL SEAL 1 1/8"	MCHSEL-SDPS00155	1
8	SHAFT SLEEVE	SHTSLV-SDPC00218	1
9	"O" RING (SHAFT SLEEVE)	ORING-SDP000051	1
10	IMPELLER	IMP-SDP100145	1
11	WEARING RING	WGRING-SDPIWR0033	1
12	PUMP CASE	CASE-SDPC00047	1
13	PROPELLER STEM	PROPSTM-SDPS00676	1
14	STRAIGHTENING VANES	STRVANE-SDPS00122	1
15	PROPELLER STEM BOLT	PROPSTM-SDPS00677	1
16	PROPELLER	PROPELR-SDPP00660-A	1
17	SUCTION HOUSING GASKET	GASKET-SDPF003829	1
18	SUCTION HOUSING	SUCHSG-SDPF00050-B	1
19	CAPSCREWS (suction housing to case)	FRSCP-SHZ-0038C-0125-2	3
20	SUCTION GASKET	FLG-ASA-SP15-CGT-0300	1
21	STUD	FRSTUD-2P-0038C-0138-2	2
22	HEX NUT	FRNUT-2HZ-0038C-2	2
23	CAPSCREWS	FRPCP-SHZ-0038C-0100-2	2
24	CAPSCREWS (MOTOR TO HEAD)	FRPCP-SHZ-0038C-0075-2	4
25	1/4" NIPPLE	NIPPLE-B-0025A150	1
26	1/4" FULL COUPLING	CLP-FGB-0025	1
27	1/4" 90° COMPRESSION	CMPTG-R-MELL-025-025	1
28	1/4" PIPE PLUG	PF-PLUGSQ-SLD-B-0025	1
29	PROPELLER SPACER	PROPSPCR-SDPS00074	1
30	WOODRUFF KEY #405	KEYWOOD-WOODRUFF-#405	1
31	#10-32 SET SCREWS x 1/4" LG	FRSET-S8-0010F-0025	2